

REVISIONS

REV.	DESCRIPTION	DATE	REVISED BY
A	ECN 11-060; DRAWING CREATED FOR A900007	06/Sep/2011	N.CLOZZA

ITEM NO.	QTY.	PART NUMBER	DESCRIPTION
1	1	3200389	ADAPTOR, INLET VALVE MOUNT
2	4	1500077	SCREW, BUTTON HEAD, 10 - 32 X 3/8
3	1	3200268	PLATE, INNER FILTER, VERTICAL
4	2	1540544	BOLT, SHCS, M8 X 1.25 X 7.5 PLT
5	2	1540553	BOLT, SHCS, M8 X 1.25 X 7.0 PLT
6	2	5830004	O-RING, VITON, 3 1/8 ID X 1/8
7	1	5830070	O-RING, VITON, 2.9/16 ID X 3/32
8	4	1570067	WASHER, SAE, 5/16

NOTES:

1. REMOVE INLET CONTROL VALVE AND INNER FILTER PLATE. TO REMOVE BUTTON HEAD SCREWS HEAT OR TAP BUTTON HEAD SCREWS TO FREE UP LOCTITE.
2. ROTATE INLET CONTROL VALVE 90 DEGREES AND INSTALL VERTICAL INNER FILTER PLATE WITH NEW O-RING AND FASTENERS. USE LOCTITE ON ALL FASTENERS
3. REINSTALL INLET CONTROL VALVE USING INLET VALVE MOUNT ADAPTER, NEW O-RINGS AND FASTENERS. USE LOCTITE ON ALL FASTENERS

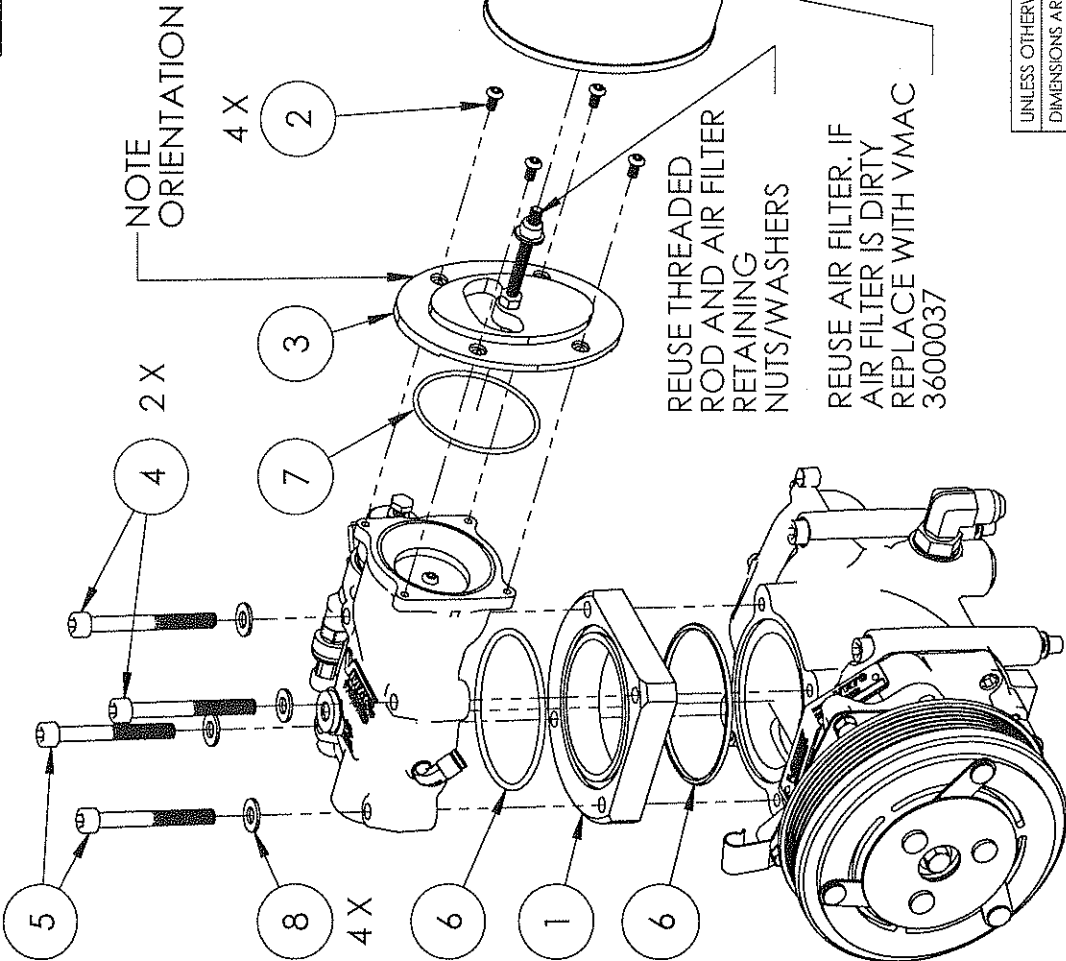

ALL SHEETS ARE THE SAME REVISION STATUS.



TITLE: **INSTRUCTIONS, A900007**

SIZE **A** DWG. NO. **1900920** REV **A**

SCALE: NTS WEIGHT: SHEET 1 OF 1

UNLESS OTHERWISE SPECIFIED:	NAME	DATE
DIMENSIONS ARE IN INCHES.	N.CLOZZA	6SEP11
FAB. TOLERANCE: STD 5100035	CHECKED BY: <i>AM</i>	6-5-2011
MACH. TOLERANCE:	APPROVED BY: <i>[Signature]</i>	
X ± .1	G.A.	
XX ± .02		
XXX ± .005		
ANGLE ± .5		
THIRD ANGLE PROJECTION	PRINT DATE:	Tuesday, September 06, 2011
DO NOT SCALE DRAWING	MATERIAL	SEE BOM
	PART #	

V900107	USED ON
NEXT ASSY	APPLICATION

PROPRIETARY AND CONFIDENTIAL
THE INFORMATION CONTAINED IN THIS DRAWING IS THE SOLE PROPERTY OF VMAAC. ANY REPRODUCTION IN PART OR AS A WHOLE WITHOUT THE WRITTEN PERMISSION OF VMAAC IS PROHIBITED.