



**ILLUSTRATED PARTS LIST FOR SYSTEM 9049 - 1998-2000 FREIGHTLINER FL50,
FL60, FL70, FL80 5.9 CUMMINS ISB**

ASSY.	ITEM	UNIT	QTY	PART#	DESCRIPTION
1.0				48224	Main Bracket Assembly
	1.1	ea	1	11130	Main bracket
	1.2	ea	1	26102	Adjustor
	1.3	ea	1	15048	7/16" Flat washer
	1.4	ea	1	15227	12mm x 90mm HHCS
	1.5	ea	1	15161	½" x 1 ¼" Flange lock HHCS
	1.6	ea	1	14051	Idler bolt spacer
	1.7	ea	1	13007	Back idler
	1.8	ea	3	15399	8mm x 38mm stud
	1.9	ea	3	15067	5/16" SAE washers
	1.10	ea	3	15008	Nut, hex pl, M8 x 1.25
	1.11	ea	1	18130	Crank shaft pulley
	1.12	ea	1	16340	VR7000 Belt
2.0				1257	Compressor Assembly
	2.1	ea	1	1202	VR7000 Compressor
	2.2	ea	1	92175	Inlet control valve
	2.3	ea	1	35363	Temperature probe
	2.4	ea	1	50064	¼" tube x 1/8" pipe 90 DEG elbow
	2.5	ea	1	50112	1/8" NPT, 45 DEG street elbow
	2.6	ea	1	35288	Pressure sensor
	2.7	ea	1	15029	¼" NC Nylok nut
	2.8	ea	1	15038	¼" SAE flat washer
	2.9	ea	1	36045	Filter cover
	2.10	ea	1	15374	¼" NC x 3" threaded rod
	2.11	ea	1	15221	¼" NC nut
	2.12	ea	1	36037	Paper filter element
	2.13	ea	1	58004	O-ring 3 1/8" ID x 1/8" wide, Viton
	2.14	ea	2	22097	Cable clamp, ¼"
	2.15	ea	1	58072	Viton, O-Ring 5/8" ID x 1/16" wide
	2.16	ea	1	49002	90 Deg elbow, JIC O-ring, ½ ¼-16
	2.17	ea	1	15481	¾" O-Ring washer
	2.18	ea	1	2035	Clutch complete 6 groove
	2.19	ea	1	50081	Elbow, BRASS npt tube 1/8-5/16



**ILLUSTRATED PARTS LIST FOR SYSTEM 9049 - 1998-2000 FREIGHTLINER FL50,
FL60, FL70, FL80 5.9 CUMMINS ISB**

ASSY.	ITEM	UNIT	QTY	PART#	DESCRIPTION
3.0				3044	VR7000 Tank
	3.1	ea	1	92199	Main tank
	3.2	ea	1	15077	10-32 x 3/8" SHCS
	3.3	ea	1	32190	Discharge cap
	3.4	ea	1	48241	Scavenge Screen Assembly
	3.5	ea	1	36064	Tank rear cap seal
	3.6	ea	1	36036	Coalescing filter element
	3.7	ea	1	58068	Compression spring
	3.8	ea	1	58066	O-Ring 4 3/4" ID x 1/8" wide, Viton
	3.9	ea	1	36054	200Psi relief valve
	3.10	ea	1	12262	Guard Plate
	3.11	ea	1	58008	O-ring 1 15/16" ID x 3/32" wide, Viton
	3.12	ea	1	32033	Sight glass window
	3.13	ea	1	15385	Retaining ring
	3.14	ea	1	50089	3/8" NPT to 1/2" SAE brass connector
	3.15	ea	1	92039	VR7000 oil filter
	3.16	ea	1	49033	3/4" NPT x 3/4" JIC steel connector
4.0					Hose kit
	4.1	ea	6	22029	Hose clamp HS10
	4.2	ea	1	17435	1/2" AQP hose / 142.0" long
	4.3	in	81	17177	3/4" Heater hose
	4.4	ea	1	17434	3/4" AQP hose / 95.0" long c/w 45 DEG elbow
	4.5	ea	1	17417	1/2" AQP hose / 41.5" long c/w 90 DEG elbow
	4.6	ea	1	17506	5/16" HT hose / 135.0" long w/tube assembly
	4.7	ea	1	17507	1/4" HT hose / 134.5" long w/tube assembly
	4.8	in	52	17177	3/4" Heater hose
	4.9	in	7.5	17177	3/4" Heater hose
	4.10	ea	1	53003	5/8" Nylon Y
	4.11	ea	1	50016	3/4" NPT x 3/4" hose barb
5.0					Throttle Control
	5.1	ea	1	5031	Throttle Control



**ILLUSTRATED PARTS LIST FOR SYSTEM 9049 - 1998-2000 FREIGHTLINER FL50,
FL60, FL70, FL80 5.9 CUMMINS ISB**

ASSY.	ITEM	UNIT	QTY	PART#	DESCRIPTION
6.0				48223	Tank Brackets
	6.1	ea	2	12257	Tank bracket
	6.2	ea	2	22130	Tank backing strap
	6.3	ea	2	22122	Tank cable strap
	6.4	ea	2	14162	Cable spacer (for use with standard frame rail)
	6.5	ea	2	22133	Cable clamp
7.0				48222	Cooler Assembly
	7.1	ea	1	92196	Cooler
	7.2	ea	2	50016	3/4" NPT x 3/4" hose barb
8.0					Electrical Assembly
	8.1	ea	1	35513	Interface cable FL
	8.2	ea	1	35412	Switch box
	8.3	ea	1	35404	Low profile control panel
9.0					Misc.
	9.1	ea	1	48161	Air brake pressure switch

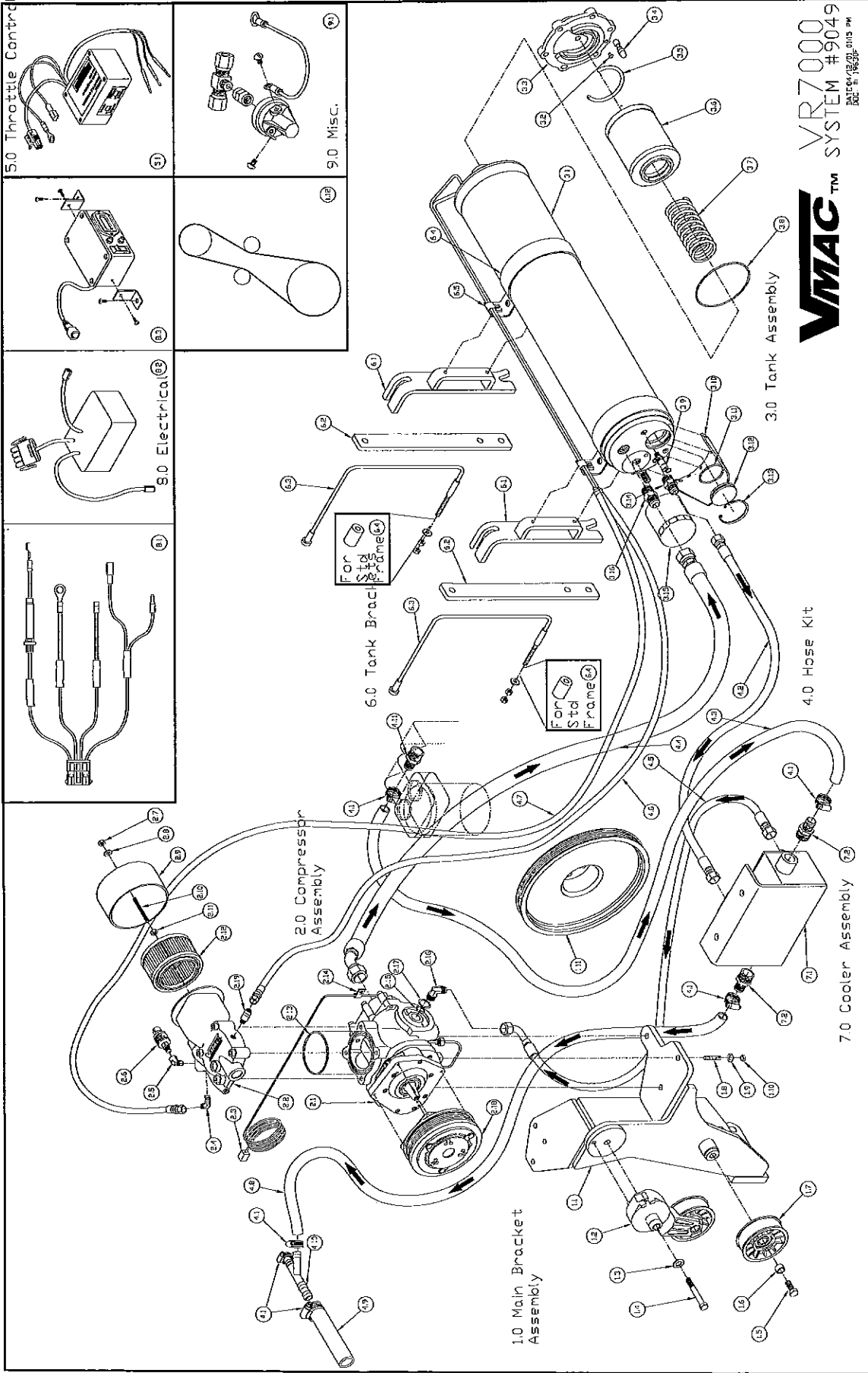

VMACTM

VR7000
SYSTEM #9049

DATE: 01/01/01 0113 PM
REV. 01/19/01