

**ILLUSTRATED PARTS LIS SYSTEM 9018 1999 NAVISTAR INTERNATIONAL MODELS
2574 & 2674 CUMMINS ISB M11**

ASSY.	ITEM	UNIT	QTY	PART#	DESCRIPTION
1.0					Main Bracket Assembly
	1.1	ea	1	11118	VR7000 Main bracket
	1.2	ea	1	26075	Tensioner, modified
	1.3	ea	1	14129	Idler spacer
	1.4	ea	2	13007	Idler, back
	1.5	ea	1	15048	7/16 washer SAE
	1.6	ea	1	15419	12 X 80 HHCS 10.9
	1.7	ea	1	OEM	Bolt and washer supplied with item 1.2
	1.8	ea	1	15403	½ x 1 ¼ idler bolt
	1.9	ea	1	14051	Idler bolt spacer
	1.10	ea	1	18133	Pulley, Inter M11 Cummins 98
	1.11	ea	5	15429	Bolts HHCS M14 x 1.5 x 80
	1.12	ea	1	12175	Bracket, Power steering gussett
	1.13	ea	1	16325	Belt, VR7000
	1.14	ea	1	16330	Belt, AC
2.0				1250	Compressor Assembly
	2.1	ea	1	1202	VR7000 compressor
	2.2	ea	1	92175	VR7000 Inlet valve
	2.3	ea	1	35288	Pressure sensor
	2.4	ea	1	50112	Elbow, street, 45 Deg., 1/8 NPT
	2.5	ea	1	50064	Elbow ¼ -1/8 NPT
	2.6	ea	1	15029	¼" nut, Nylok
	2.7	ea	1	15038	¼" SAE washer
	2.8	ea	1	36045	Filter cover
	2.9	ea	1	15374	¼" NC x 3.0" threded rod
	2.10	ea	1	15221	¼" NC nut, hex
	2.11	ea	1	36037	Paper filter element
	2.12	ea	1	50081	Elbow 1/8" – 5/16, NPT
	2.13	ea	1	58004	Viton 3 1/8" ID x 1/8 wide O-ring
	2.14	ea	1	49036	¾" JIC swivel nut 45 Deg. elbow
	2.15	ea	1	22097	Cable Clamp ¼"
	2.16	ea	1	35363	Temperature probe assembly
	2.17	ea	1	49002	Elbow, steel, JIC/O-ring, ½ x ¾-16
	2.18	ea	1	2035	Clutch
	2.19	ea	1	15481	O-ring washer
	2.20	ea	1	58072	5/8 ID x 1/16 wide O-ring viton



**ILLUSTRATED PARTS LIS SYSTEM 9018 1999 NAVISTAR INTERNATIONAL MODELS
2574 & 2674 CUMMINS ISB M11**

ASSY.	ITEM	UNIT	QTY	PART#	DESCRIPTION
3.0				3044	Tank Assembly
	3.1	ea	1	92199	Tank main body
	3.2	ea	2	22133	Clamp
	3.3	ea	1	49035	¾ - 16 Threaded Nipple
	3.4	ea	1	49033	Steel connector ¾ NPT x ¾ JIC 37 Deg.
	3.5	ea	1	92039	VR7000 Oil filter
	3.6	ea	1	15385	Retaining ring
	3.7	ea	1	32033	Sight glass window
	3.8	ea	1	58008	O-ring, 1 15/16" ID x 3/32" wide, Viton
	3.9	ea	1	12262	Guard Plate
	3.10	ea	1	50089	Brass connector 3/8 NPT - ½ SAE
	3.11	ea	1	36054	200Psi Relief valve
	3.12	ea	1	58066	O ring, viton, 4 ¾ ID x 1/8
	3.13	ea	1	58068	Compression spring
	3.14	ea	1	36036	Coalescing filter element
	3.15	ea	1	36064	Tank rear cap seal
	3.16	ea	1	15077	10-32 x 3/8 button head SHCS
	3.17	ea	1	48241	Scavenge screen assembly
	3.18	ea	1	32190	Discharge cap
4.0					Hose Kit
	4.1	ea	1	17490	¼ HT Hose w/tube assembly 5/16 x 180.5" (Tank to inlet valve)
	4.2	ea	1	17229	Hose, ¾" AQP, 136" long c/w 45 Deg. elbow (Tank to compressor)
	4.3	ea	1	17487	Hose w/tube assembly ¼ x 183.5 long (Tank to inlet valve)
	4.4	in	1	17488	Hose, ½" AQP, 156" long (Tank to cooler)
	4.5	ea	1	48210	Power steering hose assembly
	4.6	ea	1	17489	Hose, AQP ½" w/elbow 47" long (Cooler to compressor)
	4.7	ea	4	22029	Clamp hose HS10
	4.8	in	48	17177	Hose ¾"
	4.9	in	22.75	17224	Hose ½ fuel & oil
	4.10	ea	1	53028	Hose connector ¾"

**ILLUSTRATED PARTS LIS SYSTEM 9018 1999 NAVISTAR INTERNATIONAL MODELS
2574 & 2674 CUMMINS ISB M11**

ASSY.	ITEM	UNIT	QTY	PART#	DESCRIPTION
5.0					Throttle Control
	5.1	ea	1	5016	Throttle control M11
6.0					Tank Brackets
	6.1	ea	2	12173	Mounting bracket, Front
	6.2	ea	4	12174	Mounting bracket, rear
	6.3	ea	2	22069	Tank over straps
7.0				48249	Cooler Assembly
	7.1	ea	1	92207	Cooler
	7.2	ea	2	50016	Hose barb 3/4" x 3/4" NPT
8.0					Electrical Assembly
	8.1	ea	1	35583	Interface cable
	8.2	ea	1	35412	Switching Box
	8.3	ea	1	35404	Control panel, low profile
9.0					Miscellaneous
	9.1	ea	1	48161	Switch, air brake pressure

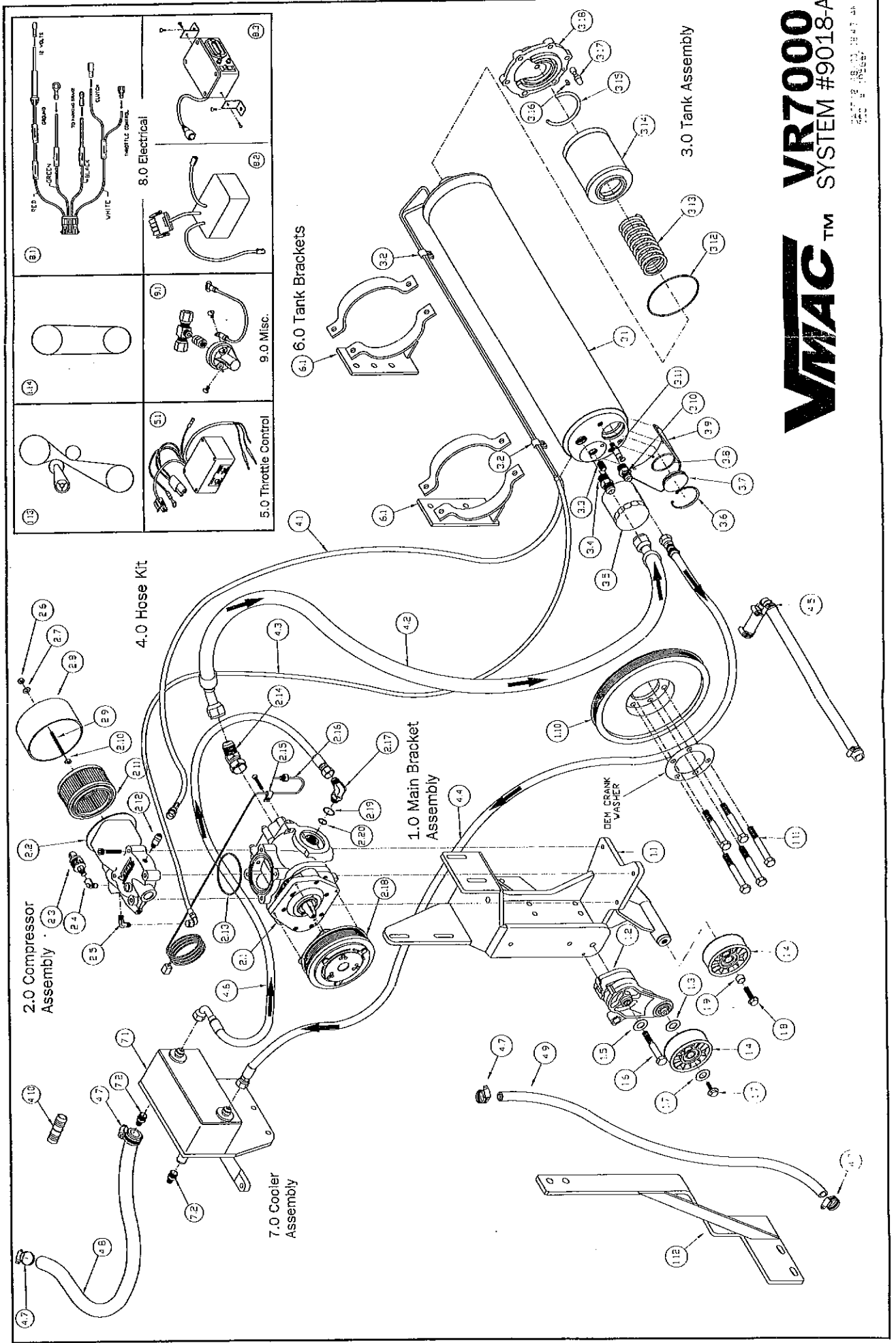

2.0 Compressor Assembly

4.0 Hose Kit

1.0 Main Bracket Assembly

3.0 Tank Assembly

6.0 Tank Brackets

7.0 Cooler Assembly

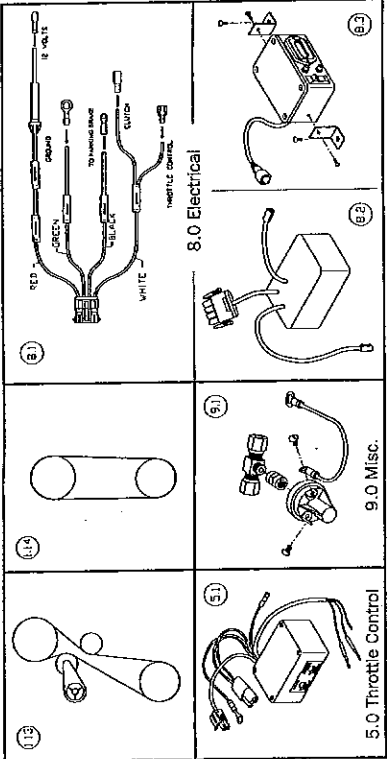

VMAC™ **VR7000**
SYSTEM #9018-A

© 1998 VMAC, Inc. All rights reserved.